

Model No.	POS.1	POS.2	POS.3
1M31	ON	NONE	ON
Term. Comm.	2-3,5-6,8-9	N/A	2-1,5-4,8-7
SCHEMATIC		N/A	

	CONTACT PLATING	TERMINAL PLATING	RATINGS
Q	Silver	Q = Silver	5 Amps @120 VAC or 28 VDC 2 Amps @250 VAC
S		S = Silver,pure-tin	
C	Gold over Silver	C = Gold over silver	
K		K = Gold over silver,pure-tin	0.4 Volt-Amps(VA) max. @20V max. (AC or DC)
R	Gold	R = Gold	
G		G = Gold,pure-tin	



PANEL MOUNTING

SPECIFICATIONS

MECHANICAL LIFE: 40,000 make-and-break cycles.
CONTACT RESISTANCE: 10 mΩ max. initial @ 2-4VDC
 100mA for both silver and gold plated contacts.
INSULATION RESISTANCE: 1,000 MΩ min.
DIELECTRIC STRENGTH: 1,000 Vrms min.@sea level.
OPERATING TEMPERATURE: -40°C to 85°C.

MATERIALS

CASE: Diallyl phthalate (DAP) (UL94v-0).
ACTUATOR: Brass,chrome plated.
BUSHING: Brass,nickel plated.
HOUSING: Stainless Steel.
TERMINAL/CONTACT: Copper alloy.
RoHS & Lead Free

Warwick Gmbh & Co Music Equipment KG
 Gewerbepark 46
 D-08258 Markneukirchen
 Tel: +49(0)37422 555-0
 Fax : +49 (0) 37422 555-9999
 e-mail : info@warwick.de

	NAME	DAE	M_80020_C_01	Copyright This drawing is the property of Warwick Gmbh & Co Music Equipment KG. The information given on it is protected by copyright and any form of copying or reproduction is stricly forbidden.
DRAWN		28/10/2024		
CHKD	MEC	A-01		
	Scale 1 : 1	SHEET 1 OF 1		

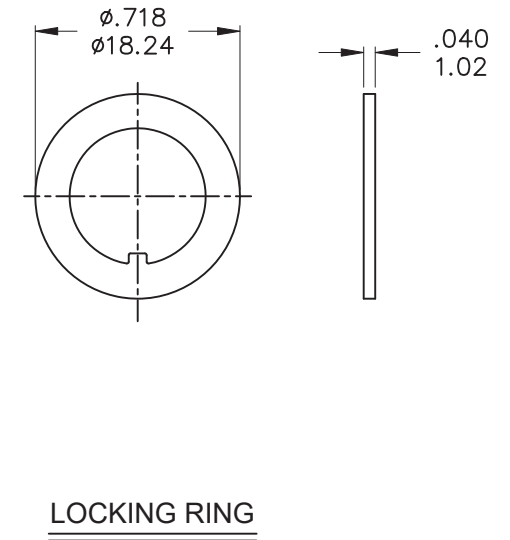
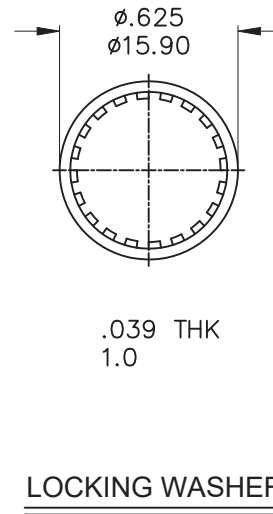
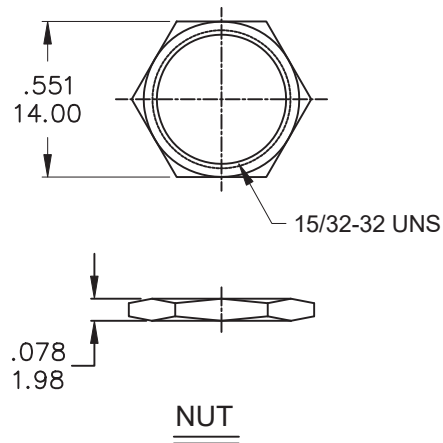

	PART NO.	PART NAME	Q'TY
1	MNU-1M07	15/32 INCH NUTS	2
2	MNU-1M08P	LOCKING RING	1
3	MNU-1M09	LOCKING WASHER	1



Warwick Gmbh & Co Music Equipment KG
 Gewerbepark 46
 D-08258 Markneukirchen
 Tel: +49(0)37422 555-0
 Fax: +49 (0) 37422 555-9999
 e-mail: info@warwick.de

Copyright

This drawing is the property of Warwick Gmbh & Co Music Equipment KG.
 The information given on it is protected by copyright and any form of copying or reproduction is stricly forbidden.

	NAME	DAE	M_8000
DRAWN	28/10/2024		
CHKD	MEC	A-01	
	Scale 1: 1	SHEET 1 OF 1	