

	CONTACT PLATING	TERMINAL PLATING	RATINGS
Q	Silver	Silver	5 Amps @120 VAC or 28VDC
C	Gold over Silver	Gold over silver	2 Amps @250 VAC
R	Gold	Gold	0.4 Volt-Amps(VA) max. @20V max. (AC or DC)



Warwick Gmbh & Co Music Equipment KG  
Gewerbepark 46  
D-08258 Markneukirchen  
Tel: +49(0)37422 555-0  
Fax : +49 ( 0 ) 37422 555-9999  
e-mail : [info@warwick.de](mailto:info@warwick.de)

	NAME		DAE	M_80014_C_01	<u>Copyright</u> This drawing is the property of Warwick Gmbh & Co Music Equipment KG. The information given on it is protected by copyright and any form of copying or reproduction is stricly forbidden.
DRAWN			28/10/2024		
CHKD	MEC		A-01		
	Scale 1 : 1	SHEET 1 OF 1	A4		

Copyright

This drawing is the property of Warwick GmbH & Co  
Music Equipment KG.  
The information given on it is protected by  
copyright and any form of copying  
or reproduction is stricly forbidden.

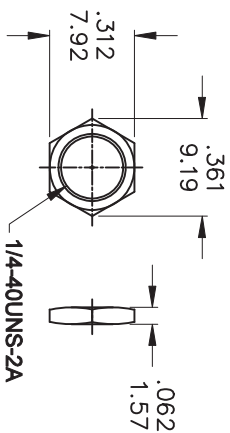

MNU-1M01A

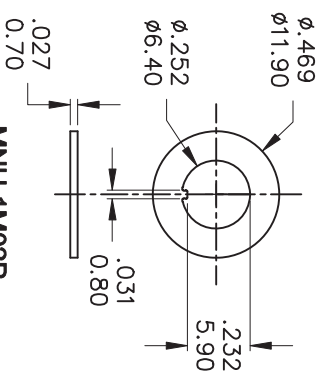

MNU-1M02P

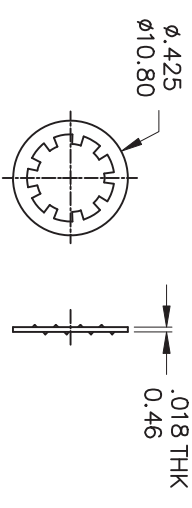

MNU-1M03

PART NO.	PART NAME	QTY
1 MNU-1M01A	1/4 INCH NUTS	2
2 MNU-1M02P	LOCKING RING	1
3 MNU-1M03	LOCKING WASHER	1



	NAME	DAE	M_8000	<p>Warwick Gmbh &amp; Co Music Equipment KG  Gewerbepark 46  D-08258 Markneukirchen  Tel: +49(0)37422 555-0  Fax: +49 (0) 37422 555-9999  e-mail: info@warwick.de</p>
DRAWN	28/10/2024			
CHKD	MEC	A-01		
	Scale 1 : 1	SHEET 1 OF 1	A4	<p>This drawing is the property of Warwick Gmbh &amp; Co  Music Equipment KG.  The information given on it is protected by  copyright and any form of copying  or reproduction is stricly forbidden.</p>

Copyright